

NewCAL

Community Update
February 17, 2022





The floor plan shows a building with the following rooms and areas:

- Gym:** 6,500 SF (Yellow)
- Classroom:** 560 SF (Purple)
- Classroom:** 320 SF (Purple)
- Conf. Room:** 320 SF (Purple)
- Art Room:** 1,020 SF (Purple)
- Activity Room:** 420 SF (Purple)
- Service:** (Orange)
- Staff Lounge:** 270 SF (Orange)
- Internship:** 110 SF (Orange)
- Staff:** 120 SF (Orange)
- Staff:** 120 SF (Orange)
- Staff:** 110 SF (Orange)
- Staff Conference:** 200 SF (Orange)
- Sto. (G):** (Grey)
- Sto.:** (Yellow)
- Cus.:** (Yellow)
- Supplies:** (Grey)
- Open to Below:** (White)
- Canopy:** (White)

The building is situated on **Highland Avenue** (North), **Walnut Street** (East), and **Walnut Place** (South). A north arrow and a scale bar (0' to 32') are provided.

Highland Avenue

Walnut Street

Walnut Place

Sto.

Gym 6,500 SF

Classroom 560 SF

Classroom 320 SF

Canopy

Conf. Room 320 SF

Open to Below

Cus.

Sto. (G)

Sto.

T

T

T

Service

Supplies

Art Room 1,020 SF

Activity Room 420 SF

Staff Lounge 270 SF

Internship 110 SF

Staff 120 SF

Staff 120 SF

Staff 110 SF

Staff Conference 200 SF

N

0' 8' 16' 32'

Highland Avenue

Walnut Street

Walnut Place

Sto.

Gym 6,500 SF

Classroom 560 SF

Classroom 320 SF

Canopy

Conf. Room 320 SF

Open to Below

Cus.

Sto. (G)

Sto.

T

T

T

Service

Supplies

Art Room 1,020 SF

Activity Room 420 SF

Staff Lounge 270 SF

Internship 110 SF

Staff 120 SF

Staff 120 SF

Staff 110 SF

Staff Conference 200 SF

N

0' 8' 16' 32'

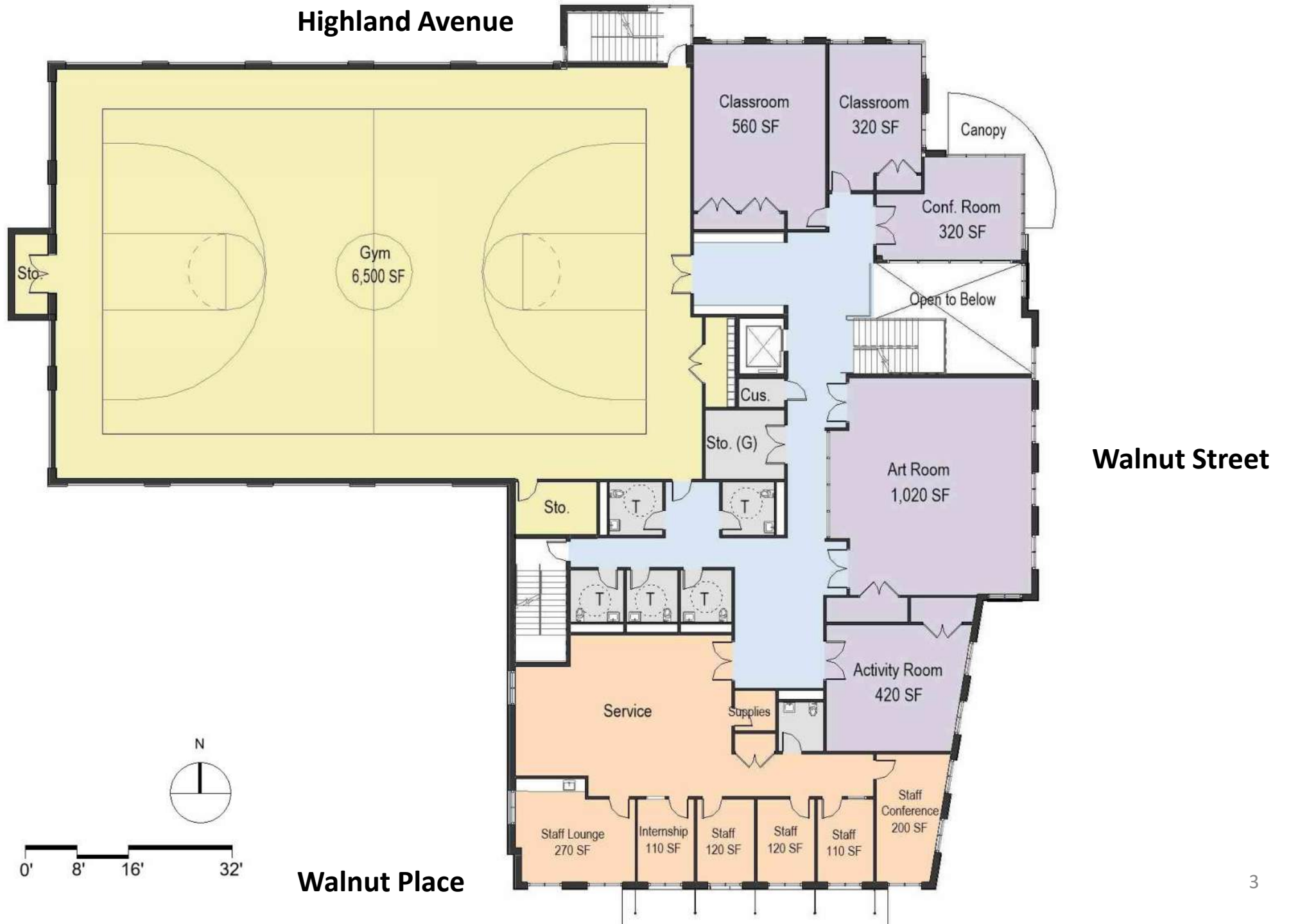

The floor plan shows a building with the following rooms and areas:

- Gym:** 6,500 SF (yellow)
- Classroom:** 560 SF (purple)
- Classroom:** 320 SF (purple)
- Conf. Room:** 320 SF (purple)
- Art Room:** 1,020 SF (purple)
- Activity Room:** 420 SF (purple)
- Service:** (orange)
- Staff Lounge:** 270 SF (orange)
- Internship:** 110 SF (orange)
- Staff:** 120 SF (orange)
- Staff:** 120 SF (orange)
- Staff:** 110 SF (orange)
- Staff Conference:** 200 SF (orange)
- Sto. (G):** (grey)
- Sto.:** (yellow)
- Cus.:** (yellow)
- Supplies:** (orange)
- Open to Below:** (white)
- Canopy:** (white)

The building is situated on **Highland Avenue** (north), **Walnut Street** (east), and **Walnut Place** (south). A north arrow and a scale bar (0' to 32') are provided.

Highland Avenue

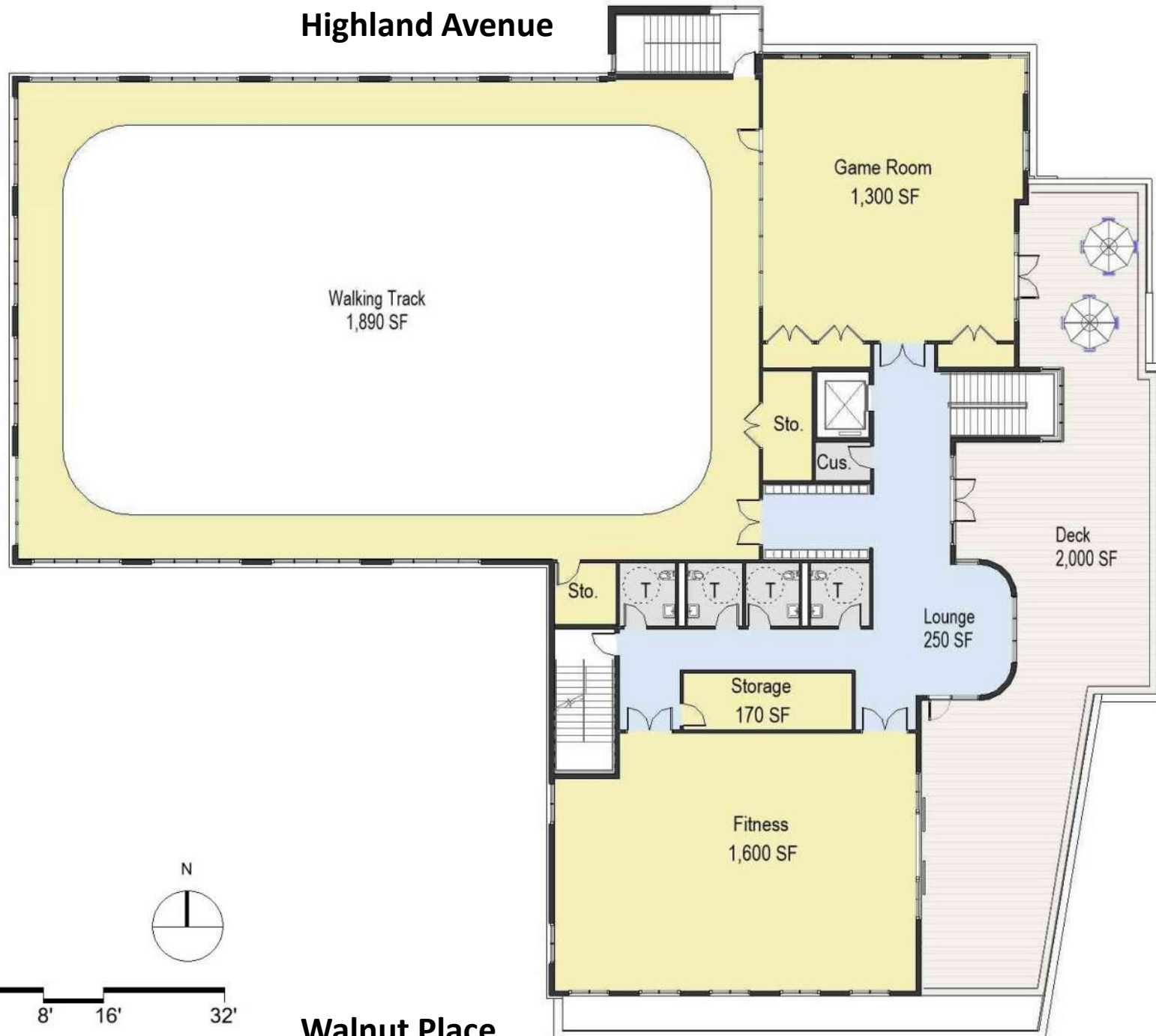

Walnut Street

Third Floor

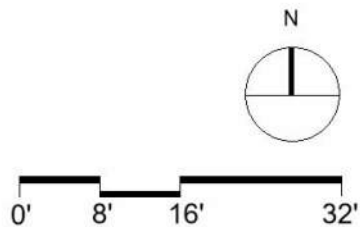

Walnut Place

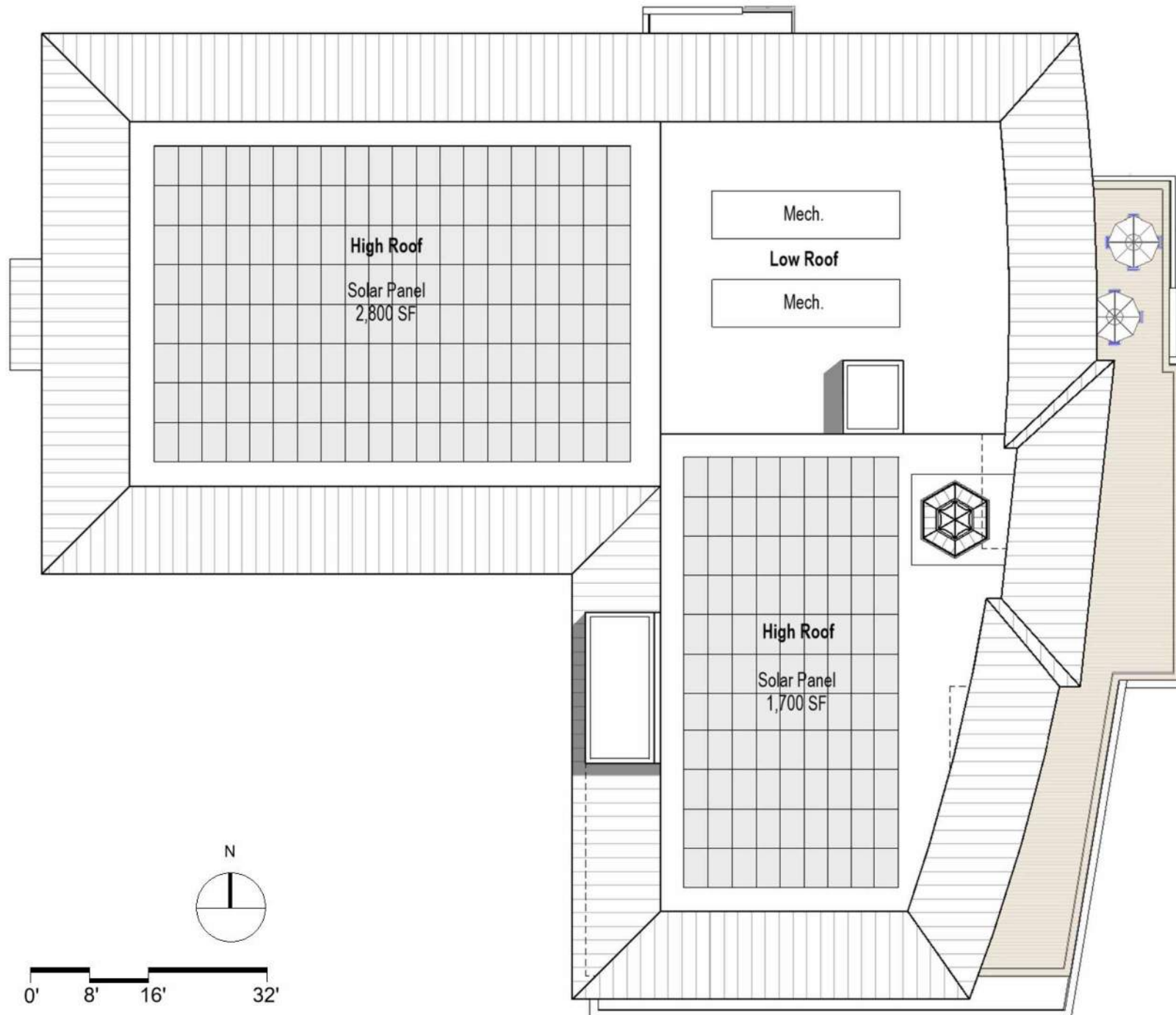

Roof Plan

Pyramidal Roof



Front Entrance – Pyramidal Roof



Walnut Street and Highland Avenue – Pyramidal Roof



Walnut Street and Walnut Place – Pyramidal Roof



Walnut Street Elevation – Pyramidal Roof



Highland Avenue Elevation – Pyramidal Roof

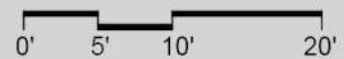



Walnut Place Elevation – Pyramidal Roof

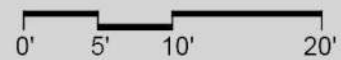

Gable Roof



Front Entrance – Gable Roof



Walnut Street and Highland Avenue – Gable Roof



Walnut Street and Walnut Place – Gable Roof



Walnut Street Elevation – Gable Roof

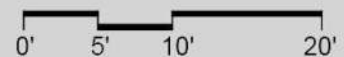



Highland Avenue Elevation – Gable Roof

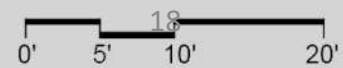



Walnut Place Elevation – Gable Roof

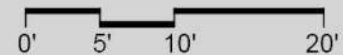

Street Perspectives



Walnut Street Entrance – Pyramidal Roof



Walnut Street Entrance – Gable Roof 21



Walnut Street – Pyramidal Roof



Walnut Street – Gable Roof



Walnut Street – Pyramidal Roof



Walnut Street – Gable Roof

Materials

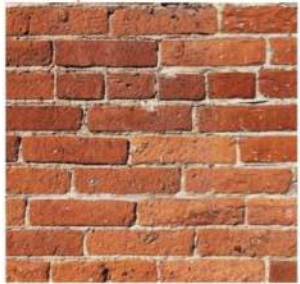

Brick



Shingle Roofing



Cladding



Connick Studio Stained Glass Panels



Limestone

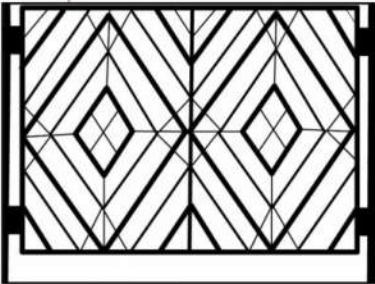

Wrought Iron Railing



Decorative Panel



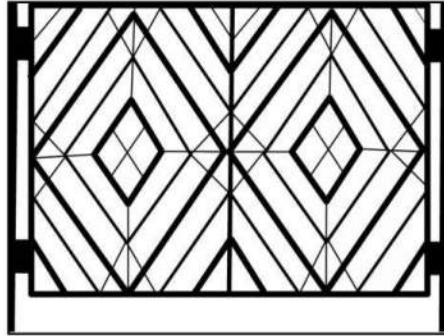
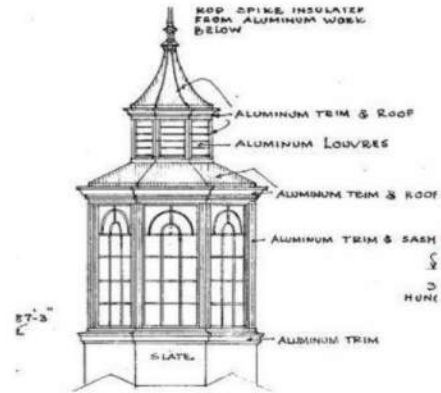

Original 1938 Cupola Design

Decorative Railing

Decorative Panels



Mending Wall
-Robert Frost



There is no frigate like a book
-Emily Dickinson

Connick Studio Stained Glass





Thank you
Questions and Comments

Walnut Street Entrance – Pyramidal Roof



Walnut Street Entrance – Gable Roof